

## POWERED FLEX CONVEYOR WORKSHEET

Company \_\_\_\_\_ Date \_\_\_\_\_  
 Contact \_\_\_\_\_ Quote Due \_\_\_\_\_ Desired Delivery \_\_\_\_\_  
 Phone No. \_\_\_\_\_ Contact Email \_\_\_\_\_ State \_\_\_\_\_  
 Sales Contact \_\_\_\_\_ Quote #: \_\_\_\_\_  
 Quantity \_\_\_\_\_

### Product Specs:

Max: \_\_\_\_\_  
 Width (inches): \_\_\_\_\_ Length (inches): \_\_\_\_\_  
 Height (inches): \_\_\_\_\_ Weight (lbs): \_\_\_\_\_  
 Min:  
 Width (inches): \_\_\_\_\_ Length (inches): \_\_\_\_\_  
 Height (inches): \_\_\_\_\_ Weight (lbs): \_\_\_\_\_  
 Description: \_\_\_\_\_  
 Max. Qty.: \_\_\_\_\_ Total Live Load: \_\_\_\_\_  
 Capacity Limitations (must meet all three)  
 15 lbs/roller, 50 lbs/ft, 100 lbs/zone

### Conveyor Construction:

Between Frame (BF):  18"  24"  30"  36"  
 Expanded Roller Centers:  3"  4"  5"  
 Expanded Length:  25'  40'  50'  60'  80'  
 \*Note: custom lengths are available, consult factory  
 Casters:  5"  6"  8"

### Height:

30" TOR, +/- 4" adjustment  
 34" TOR, +/- 4" adjustment  
 \_\_\_\_\_

### Speed:

Fixed \_\_\_\_\_ FPM  
 Variable \_\_\_\_\_ to \_\_\_\_\_ FPM

### Options:

Flexible Side Guides  Interface Kit  
 Reversing Stop  Stopping Photo-eye

Approval Drawing Required:  Yes  No

### Roller Specs:

1.4" roller diameter, 18 ga  
 1.9" roller diameter, 16 ga.

### Application Type:

Transportation  Loading  
 Accumulation  Unloading  
 Both

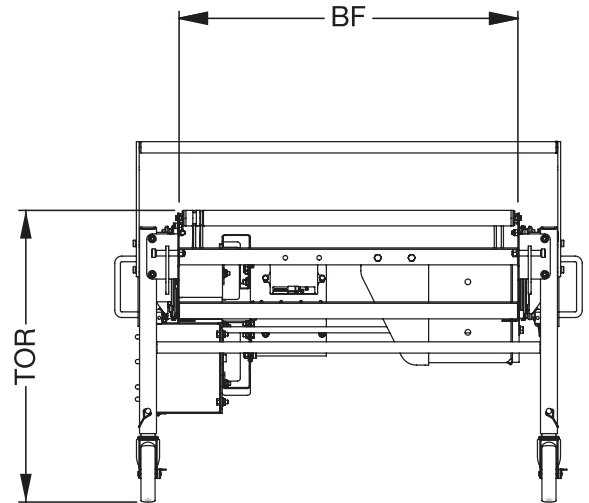

### Impact Cart:

Integrated  Powered  
 Stand Alone  Gravity  
 1.9" roller diameter, 16 ga.  
 2.6" roller diameter, 10 ga.

Notes: \_\_\_\_\_  
 \_\_\_\_\_  
 \_\_\_\_\_  
 \_\_\_\_\_